

**Window Measurement Form**



4673 Aircenter Circle Reno, Nevada 89502  
 www.soundproofwindows.com Sales@soundproofwindows.com  
 Office (877) 438-7843 Fax (877)226-4063

Name: \_\_\_\_\_

Address: \_\_\_\_\_

Email: \_\_\_\_\_

Phone(day): \_\_\_\_\_ (evening): \_\_\_\_\_

Window # \_\_\_\_\_  
 Window \_\_\_\_\_  
 Location: \_\_\_\_\_

**Measurements:**

Width | 1-  
 | 2-  
 | 3-

Height | 4-  
 | 5-  
 | 6-

**The Color You Want:**

White  
 Bronze Anodized  
 Clear Satin Anodized  
*Custom colors are available*

**How does this window open?**

Up & Down       Slides left/right  
 Fixed - does not open     Cranks Open  
 Other \_\_\_\_\_

**Is there a window sill?**

Yes     No

**Wall to window depth:** \_\_\_\_\_ Inches

**Window Frame Mounting Style preferred:**

1: Surface Mount  
 2: Surface with Sill  
 3: **Standard** Flush Mount

Notes:

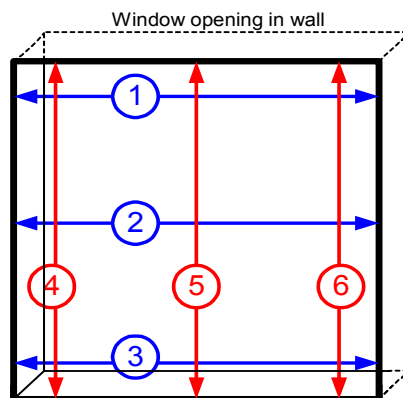

**Window Frame Mounting Styles**

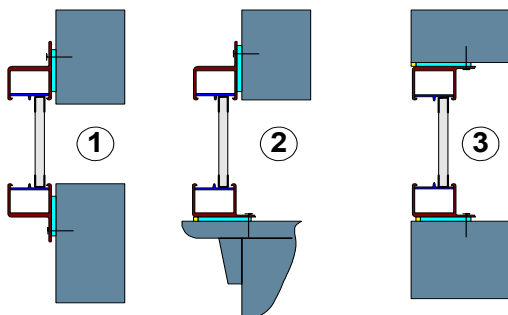

Window # \_\_\_\_\_  
 Window \_\_\_\_\_  
 Location: \_\_\_\_\_

**Measurements:**

Width | 1-  
 | 2-  
 | 3-

Height | 4-  
 | 5-  
 | 6-

**The Color You Want:**

White  
 Bronze Anodized  
 Clear Satin Anodized  
*Custom colors are available*

**How does this window open?**

Up & Down       Slides left/right  
 Fixed - does not open     Cranks Open  
 Other \_\_\_\_\_

**Is there a window sill?**

Yes     No

**Wall to window depth:** \_\_\_\_\_ Inches

**Window Frame Mounting Style preferred:**

1: Surface Mount  
 2: Surface with Sill  
 3: **Standard** Flush Mount